



Kathmandu



CONFIGURE WING PITCHING INSTRUCTIONS

PR100957

CONTENTS:

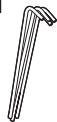

PEGS x 6



PEG STORAGE BAG

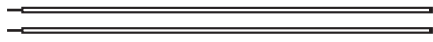

STEEL POLES x 2

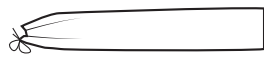

POLE STORAGE BAG



STORAGE BAG



GUYS LINES x 6

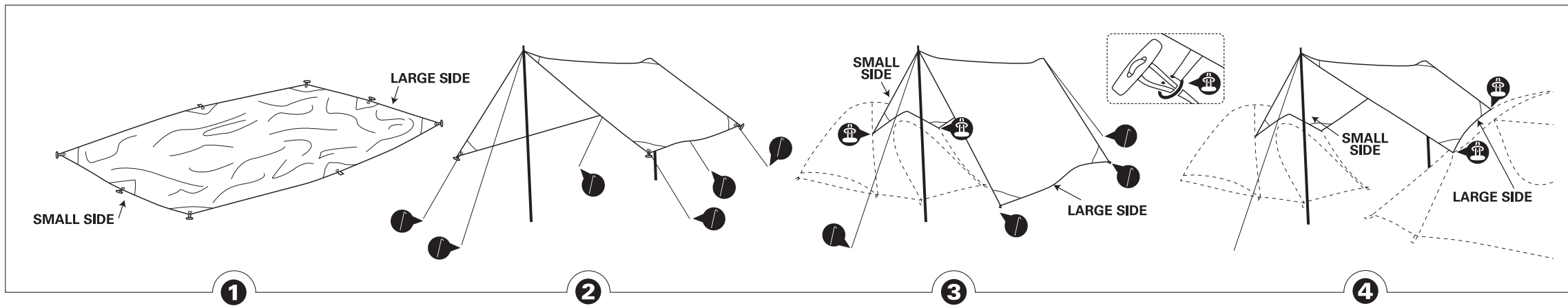



Kathmandu

CONFIGURE WING PITCHING INSTRUCTIONS

HINTS ON SITE SELECTION AND GENERAL USE

- Remove any sharp objects and stones from the site.
- Certain substances such as bird droppings and tree sap can damage the tent, so avoid pitching it directly underneath trees.
- Pitch the tent so the doorway is sheltered from prevailing winds.
- Exposure to UV rays will eventually damage and weaken any fabric. To extend the life of your tent, it is recommended to pack it away when not in use, rather than leaving it pitched for long periods.
- This tent is not specifically designed for adverse weather. If strong winds and heavy rain are to be expected on your trip, please consider your safety and seek permanent shelter.
- Water vapour from your breath or wet clothing causes condensation to form as water droplets inside the tent. This is NOT leakage and can be reduced by good ventilation and by hanging washing outside.

- Always take care with open flame near the tent. We recommend that you do NOT cook inside due to the risk of fire and the build-up of harmful gases.

- Pitch your tent at home beforehand so that you are familiar with it.

NOTE: This tent must be fully and correctly pitched following these instructions, using all pegs supplied – failure to do so may void the warranty.

CARE INSTRUCTIONS

- Avoid using aerosols and any solvent-based products (e.g. fly spray, hair spray, deodorants, petrol, kerosene, alcohol and detergents) in or around your tent. These can damage the components and fabric, including the waterproofing treatments.
- To avoid damaging the floor, place an additional layer under furniture (tables, chairs, beds etc).
- Failure to assemble the poles correctly can damage them. Avoid standing on assembled poles when they are laid out on the ground.
- When removing stubborn pegs from the

ground, use another peg to hook on the peg itself. Do not use the tent webbing or bungee loops to pull them out.

- Before storing, clean off any dirt with a damp cloth and mild soap. Remove any twigs or leaves.
- Do not machine wash your tent.
- Only store your tent when it is completely dry. Storing the tent wet can damage waterproof coatings, corrode the poles and cause mildew to grow. Note that webbing, zips and bungee take longer to dry.
- Store all poles and pegs separately in the bag provided to avoid damaging the tent fabrics.

WARRANTY

Kathmandu Ltd. warrants that all Kathmandu tents will be free from defects in materials and workmanship for 3 years from the date of purchase.

The Warranty applies only to tents used for reasonable (noncommercial) personal camping. The Warranty does not apply where any defect

arises from ordinary wear and tear, neglect or misuse of the product by the user, where the instructions of Kathmandu Ltd. regarding the use or maintenance of the tents have not been followed or otherwise where any defect arises outside the control of Kathmandu Ltd.

To claim the Warranty the tents should be returned to a Kathmandu store with the receipt as proof of purchase. This Warranty does not cover freight or delivery costs between Kathmandu and the customer.

The Warranty is an addition to, and does not affect, any rights and remedies you are entitled to under the Australian Consumer Law, New Zealand Consumer Guarantees Act 1993 or any other law that applies to Kathmandu tents.

In Australia, our goods come with guarantees that cannot be excluded under the Australian Consumer Law.

You are entitled to a replacement or refund for a major failure and for compensation for any other reasonably foreseeable loss or damage. You are also entitled to have the goods repaired or replaced if the goods fail to be of acceptable quality and the failure does not amount to a major failure.

Kathmandu Ltd.
PO Box 984
South Melbourne, VIC 3205
+61 3 9267 9999

Kathmandu Ltd.
11 Mary Muller Drive
Christchurch 8022
+64 3 373 6110

Kathmandu UK
11-13 Queens Road, Clifton
Bristol BS8 1QE
United Kingdom

For copies of these pitching instructions and additional information go to:

www.kathmandu.co.nz
www.kathmandu.au.com
www.kathmandu.co.uk

